

# 300

S. LEWIS ROAD, UNIT L

CAMARILLO, CALIFORNIA

VENTURA COUNTY



## For Lease

## 11,302 SF

INSTITUTIONALLY MANAGED | FLEXIBILITY TO GROW IN A PORTFOLIO | DELIVERING UNPRECEDENTED CUSTOMER SERVICE

FOR INFORMATION, CONTACT:

GRANT HARRIS  
805.626.1212  
CA License #01029619

JOHN OCHOA, SIOR  
805.626.1208  
CA License #00986604

GRANT FULKERSON, SIOR  
818.449.4401  
CA License #01483890

### Multi-Tenant Industrial Building

- Outstanding Industrial Space
- Dock High and Ground Level Loading
- 1 Mile South of 101 Freeway / Major Street Identity
- **Lease Rate:** \$0.84 PSF Modified Gross\*
- Available 05/01/2020

*\*Plus a \$.07 per square foot estimated Common Area Maintenance (CAM) fee.*



LEE & ASSOCIATES  
COMMERCIAL REAL ESTATE SERVICES  
Corporate ID #01191898



**Rexford  
Industrial**

# Property Specifications

	UNIT L
Available:	11,302 SF
Lease Rate:	\$0.84 PSF*
Total Building Size:	215,128 SF
Land Area:	15.78 Acres
Office Size:	1,120 SF
Zoning	M1
Year Built:	1964 (R 2006)
Power:	200A 277/480V
Loading:	(2) DH 7'10" x 9' (1) GL 7'10" x 9'
Min Clear Ht:	17.5 Feet
Parking:	22 Spaces

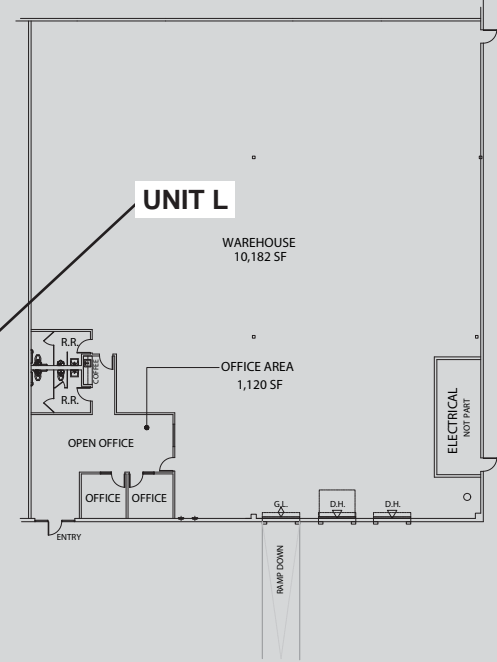
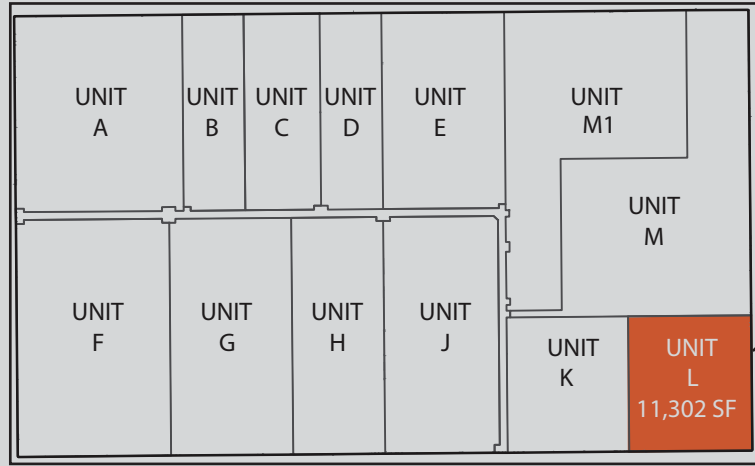

\*Plus a \$.07 per square foot estimated CAM fee. Tenant to verify all information.

# For Lease

# 11,302 SF

300 S. LEWIS ROAD, UNIT L, CAMARILLO, CA

VENTURA COUNTY

