

**31113 VIA COLINAS**

**FOR SALE**

**WESTLAKE VILLAGE, CA. 91362**

**31113**



**LEE & ASSOCIATES**  
COMMERCIAL REAL ESTATE SERVICES

**MIKE TINGUS**

President

818.223.4380

[mtingus@lee-re.com](mailto:mtingus@lee-re.com)

DRE# 01013724

**GRANT FULKERSON, SIOR**

Principal

818.304.4956

[gfulkerson@lee-re.com](mailto:gfulkerson@lee-re.com)

DRE# 01483890

No warranty or representation is made to the accuracy of the foregoing information. Terms of sale or lease and availability are subject to change or withdrawal without notice. CID #01191898





HIGH IMAGE



EQUIPPED W/  
SOLAR PANELS



DOCK HIGH &  
GRADE LEVEL



ADJACENT TO  
4 SEASONS



IMMEDIATE  
FREEWAY ACCESS



NUMEROUS RETAIL  
AMENITIES NEARBY

SALE PRICE: \$5,950,000 (±\$525 PSF)

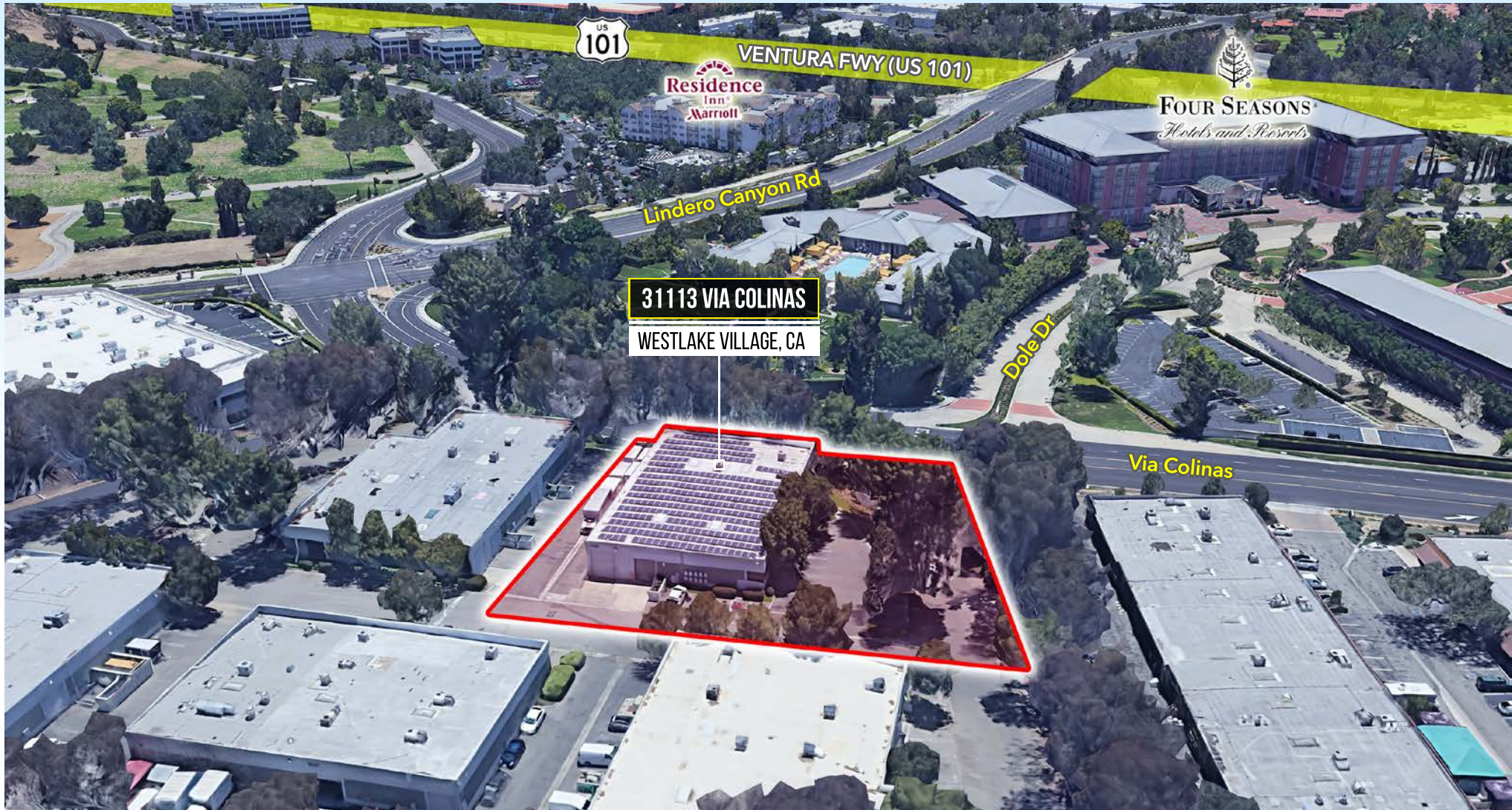



**BUILDING SIZE:**  
11,352 SF



**TOTAL OFFICE:**  
±3,500 SF



**CLEAR HEIGHT:**  
±17 FT



**LOADING:**  
1 DH/ 1 GL



**POWER:**  
400 AMPS/  
SOLAR PANELS

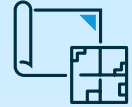

**ZONING:**  
MI



**YEAR BUILT:**  
1977



**PARKING:**  
22 SPACES (2/1000)

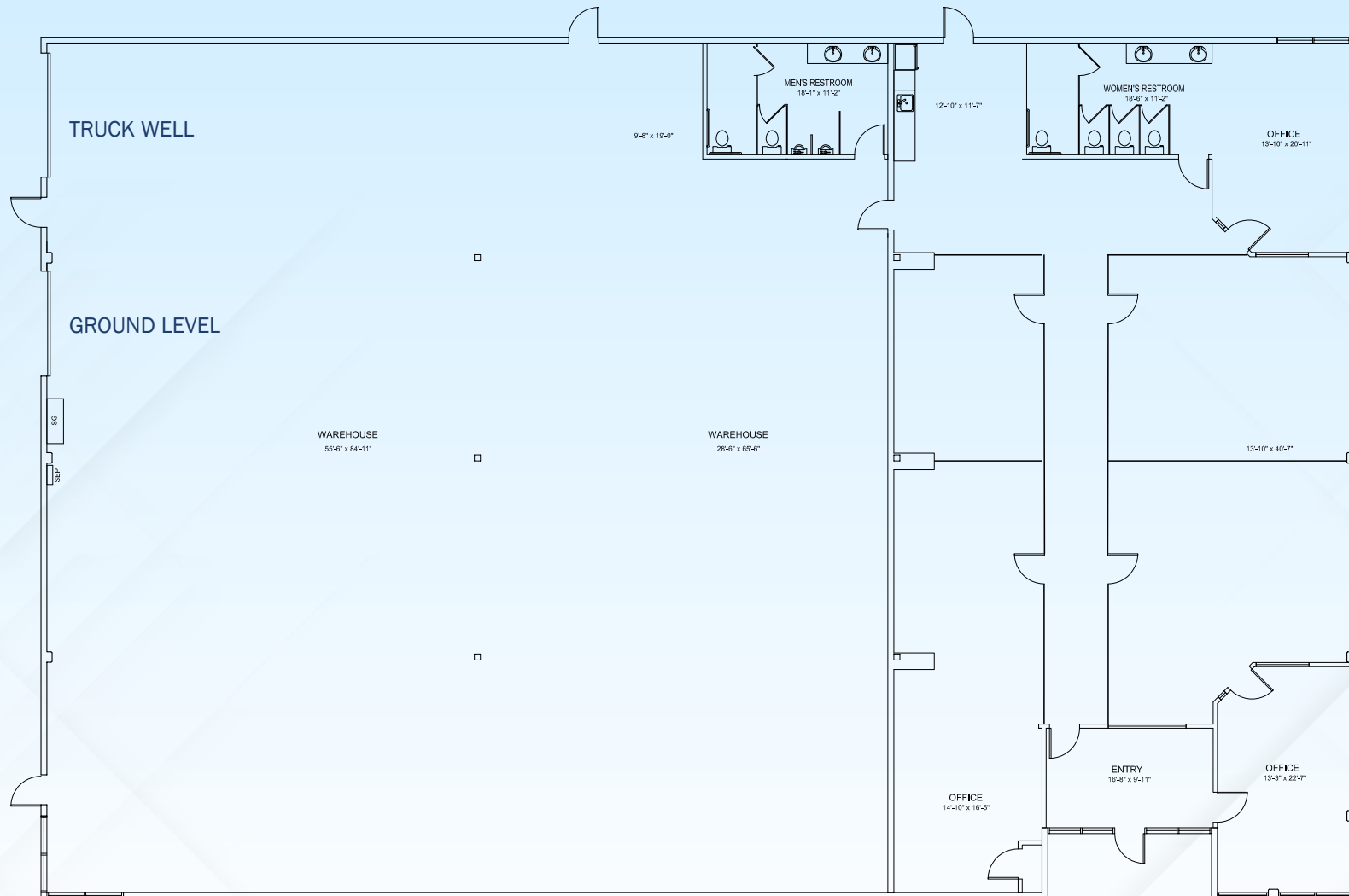

FLOOR PLAN NOT TO SCALE





**LEE & ASSOCIATES**  
COMMERCIAL REAL ESTATE SERVICES

Lee & Associates®  
LA North/Ventura, Inc.  
Corporate ID #01191898  
A Member of the Lee & Associates  
Group of Companies  
5707 Corsa Avenue, Suite 200  
Westlake Village, CA 91362  
P 818.223.4388 F 818.591.1450  
www.lee-associates.com

**MIKE TINGUS**  
President  
818.223.4380  
mtingus@lee-re.com  
DRE# 01013724

**GRANT FULKERSON, SIOR**  
Principal  
818.304.4956  
gfulkerson@lee-re.com  
DRE# 01483890





Lee & Associates®  
 LA North/Ventura, Inc.  
 Corporate ID #01191898  
 A Member of the Lee & Associates  
 Group of Companies  
 5707 Corsa Avenue, Suite 200  
 Westlake Village, CA 91362  
 P 818.223.4388 F 818.591.1450  
[www.lee-associates.com](http://www.lee-associates.com)

**MIKE TINGUS**  
 President  
 818.223.4380  
[mtingus@lee-re.com](mailto:mtingus@lee-re.com)  
 DRE# 01013724

**GRANT FULKERSON, SIOR**  
 Principal  
 818.304.4956  
[gfulkerson@lee-re.com](mailto:gfulkerson@lee-re.com)  
 DRE# 01483890

No warranty or representation is made to the accuracy of the foregoing information. Terms of sale or lease and availability are subject to change or withdrawal without notice. CID #01191898